



XHD2 Load Cells



The XHD2 load cell system is ideal for permanent installations under large cattle crushes/chutes where there is high usage. The system includes four 1,136 kg (2,500 lbs) load cells with a total capacity of 4,500 kg (10,000 lbs). Designed for harsh environments the system is protected to prevent moisture and corrosion damage.

Features and Benefits

- **Rugged.** Strong and durable construction for large crush/chute installations.
- **Plug-and-Play.**

Use with any weigh scale indicator in the Tru-Test range without calibration. Push fit cable connectors in junction box.



- **Plated and sealed load cell.** Protects against moisture and corrosion damage for permanent outdoor installation.

Load Cell Specifications



Capacity	4x 1,136 kg (2,500 lbs) load cells with a total capacity of 4,500 kg (10,000 lbs).
Accuracy	1% or 2 resolutions whichever is greater
Sensitivity	0.266 mV/V @ 2,500lb
Cable length	8 m (26')
Carton weight	Single cell 3.65 kg (8 lbs)
Environmental	Operating temperature +15 to +105 °F (-10 to +40°C) Storage temperature -5 to +120 °F (-20 to +50 °C)



Order Information

Description	Product Image	Part Number	Barcode
XHD2 Load Cell System (Includes Four cells, mounting brackets and junction box)		826906	9414731419115
XHD2 Load Cell Kit (Includes Four cells and junction box)		826907	9414731419122

Spare Parts

Description	Product Image	Part Number	Barcode
Spare load cell XHD2		826908	9414731419139
XHD load cell bracket (Includes concrete anchor plate and crush/chute mounting plate)		806896	9414731379570
Spare junction box kit XHD2 (Includes junction box and home run cable)		826910	9414731419153
Spare cable home run XHD2		826911	9414731419160

Note: Older XHD cells (part numbers 807897 & 808111) are not compatible with XHD2 cells as they have a different sensitivity. For spare parts ensure you order the correct cell, as all four cells in the system must be the same type.



Cell Dimensions

*Inches only

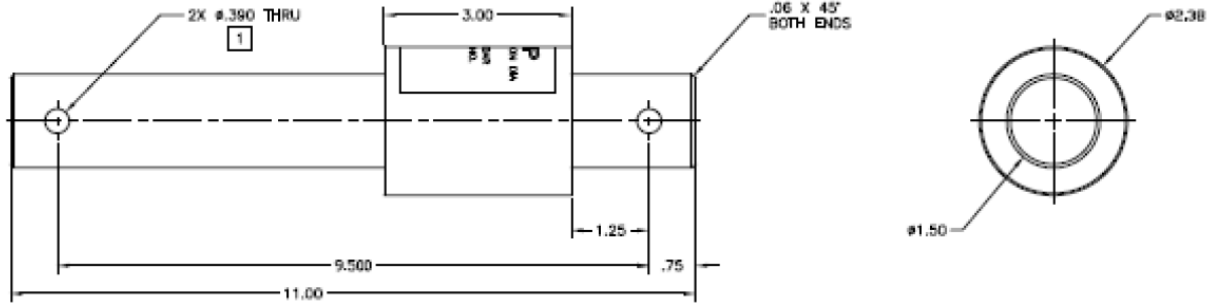

Bracket Dimensions

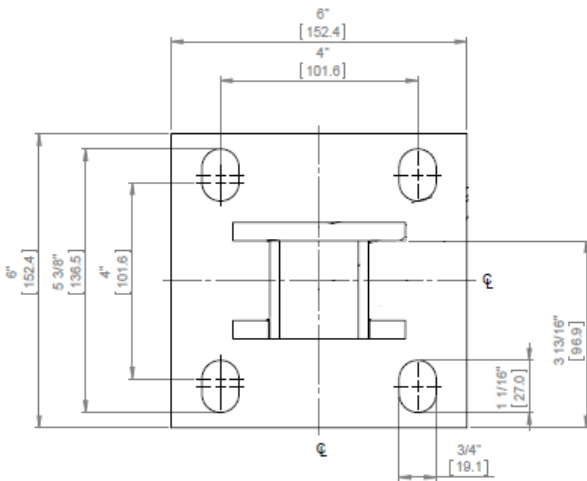

Concrete anchor plate

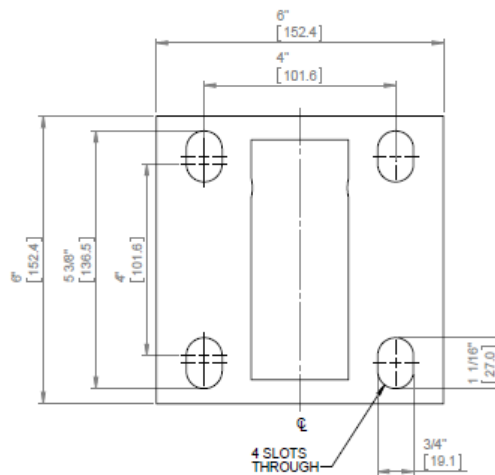

Chute/Crush mounting plate

Tru-Test Group
 PO Box 51078 Pakuranga
 Manukau 2140
 New Zealand
 Phone +64 9 978 8888
 Fax +64 9 978 8889



[THIS PRODUCT INFORMATION SHEET IS NOT INTENDED FOR DISTRIBUTION TO END USERS]

Although the information presented in this Product Information Sheet is believed to be accurate and reliable, no responsibility for inaccuracies can be assumed by Tru-Test Limited. Performance data is typical only and variations due to component manufacturing tolerances are normal. Tru-Test Limited reserves the right at any time to change performance characteristics or specifications without prior notice. All trade marks with an * are not owned by Tru-Test and belong to their respective owners. © Tru-Test Limited 2013 – All rights reserved.

The Bluetooth® word mark and logos are owned by Bluetooth SIG, Inc. and any use of such marks by Tru-Test Limited is under licence.